

ABRAHAM CHUN AHN
ADRIAN SMITH AND
GORDON GILL
ADRIAN SMITH AND

JETU PARI
JOHN MARY
JOHN S. MITCHELL
JONG SOO CHO

HAN JI TEON
NYAMTSOGT OLSANTSEREN
BATBAR TSEYEWAVDAN
OH WOREUN

YENA YOUNG
MARCO CANEVACCI
YEONGHWAN LIM
YONGMAN KIM

GORDON GILL
ALASTAIR HALL AND
IAN MCKNIGHT
ALEXANDRE COSTA LOPES

JOONGWON LEE
KYUNG-A LEE
JOERGEN MAYER H
JUNG WON YOON

PARK JONGMIN
PARK SEUNG HONG
PROFESSOR GUNTHER HENN
REGWER KWAN MATHEW G

YONG SEOK JOHN
JONGSOONG KIM
TOO HAN KIM
TOO CHUN

WITH ANTONIO COSTA LOPES
AND LANDPLAN
ANASTASIOS TELLOS G
DESIGNER ZAYRAB

JUNG WOOONG SIK
JUNGMIN NAM
JUNWON KIM
KANG HO WON

KAGAN MICHEL
ROBERT JAN VAN SANTEN
RDH HEDUNG RAE
ROH SEUNGROM

YOON JAEMIN
YOUNGKYOON JEONG G
NAMSEUNG CHO

ANDREA LIVERANI
ENRICO MOLteni
ANDREW JAMES
AN DR TAN LOKE MUN

HANGSOO LEE
KEES CHRISTAANSE
HAN VAN DEN BORN
GUURO GIETEMA

BYU CHUL
S. SAKHUR, J. JAYSGALAN
S. SAKHUR, L. GANBAT
G. NARANBEREL

BAE GEE-DOO

IRMA VAN OORT

SANG HOON, HYUN

BALDAN DASHDAMBA

KEN SUNGJIN MIN

SANG YUN, LEE

BRET WIGGINS

KERL YOO

SANGHOON LEE

JAYSON LEE

KIM DONG JIN

SANG-JIN PARK

DARRYL CUSTER

KIM HOMIN

SANGKYU JEON

MATT BILLERBECK

KIM HONGGEUN

SEO, INHYUNG

BYUNGAN YOO

KIM HYUNG WOO

SEUNGHO YU

BYUNGYOON KIM

KIM IN-CHEURL

SEUNGJO LEE

CHANG, YONG-SOON

KIM JO EUN

SHEEN, DONG JAE

CHO, BYOUNGSOO

KIM YONG-NAM

SHIN JONG HOON

CHO, DO YEUN

KI-SEOK KIM /

SHIN SAMHO

CHOI YU-JONG

KEUK-RAE JOE

SIM, KYUYOUNG

CHOI, PETER SANG-IK

KO YOUNGSUN

SO, BYUNG SIK

CHUNG KEE LEE

KOO SEUNG MIN

SEOK, KANG HEE

DAEWHA KANG

KOO, SEUNGHOI

SONG, JOO WON +

DOKWON PARK

PARK, MIJUNG

JEONG, MYOUNG HOON

INTERNATIONAL

INVITATIONAL EXHIBITION



ANDREA LIVERANI, ENRICO MOLTENI

Liverani/Molteni architetti

PARK KENNELS

Monza, Milano, Italy

The public Park Kennels in Monza has been proposed as a new model for the treatment of animals, their recovery and integration, as a new site opened to the interaction with people. A very rational and pragmatic kennel but very much combined with nature: a kind of garden where different pavilions – dogs and cats ones- are placed 45° rotated to each one into the green. A covered connection between the 4 pavilions and the main building is articulated in different canopies and a long porch. The central court yard, where all the buildings open, is proposed as a central pedestrian area with big trees.

Static structural parts of the 4 pavilions are made of wood with a constant step of 2x8 m, with external pillars. The wooden structure is repeated for 80 times as a modular system. The minimum dimension of each animal box is 3,5 closed sqm and 5,4 opened sqm, 9 sqm total area.

All the services and medical rooms are instead organized in one building, single floor, 100m long, placed to the south of the whole area. The building is built entirely in on-site cast concrete.

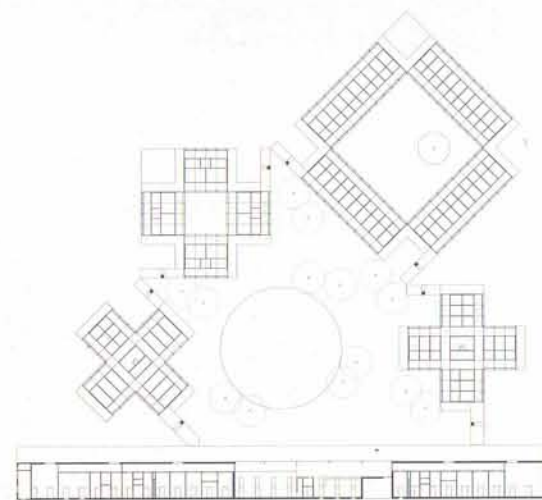

Plan

34

Location: Monza, Milano, Italy
 Site area: 11,300m²
 Gross floor area: 2,430m²
 Design period: 2008 - 2014



35